

How to add a Printer on the Network: Windows

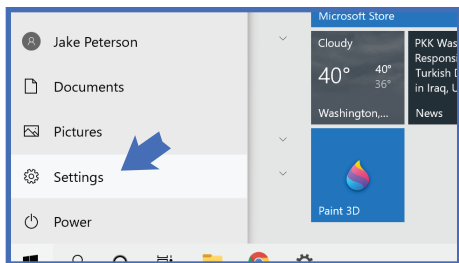

The MERIT Quick Guides are a series of step-by-step instructions to help you harness the power of technology.



1

Select the Start button in the bottom-left corner of the screen, then go to **SETTINGS**.

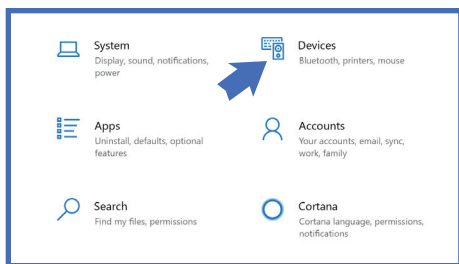

2

Click **DEVICES**.

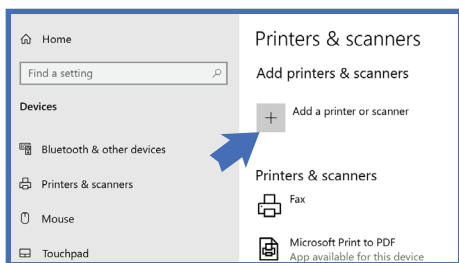

3

Click **PRINTERS AND SCANNERS**. Choose **ADD A PRINTER OR SCANNER**.

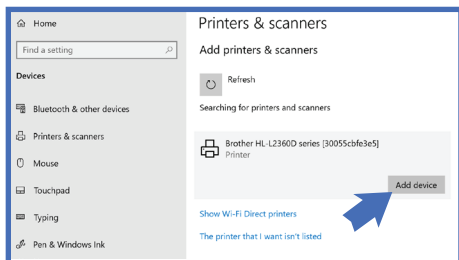

4

Allow Windows to find the nearby printers, then click the one you want to use. Finally, click **ADD DEVICE**.

About MERIT 2.0

MERIT was founded in 1983 and was re-branded in 2020 as MERIT 2.0. Our Mission Statement is *To educate every worker at every client and provide them the technology to improve.*

Quick Guides copyright by MERIT 2.0 and may not be copied or redistributed without permission.

How to Contact MERIT 2.0

SERVICE/REPAIRS/HELPDESK:
 service@meritsolutions.net
 or call 757-420-5150

www.meritsolutions.net

MARKETING:
 marketing@meritsolutions.net
 or call 757-420-5150 x7007